

Fitting instruction

Ford  
Puma  
2020

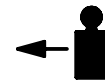

1760 kg



1100 kg



75 kg

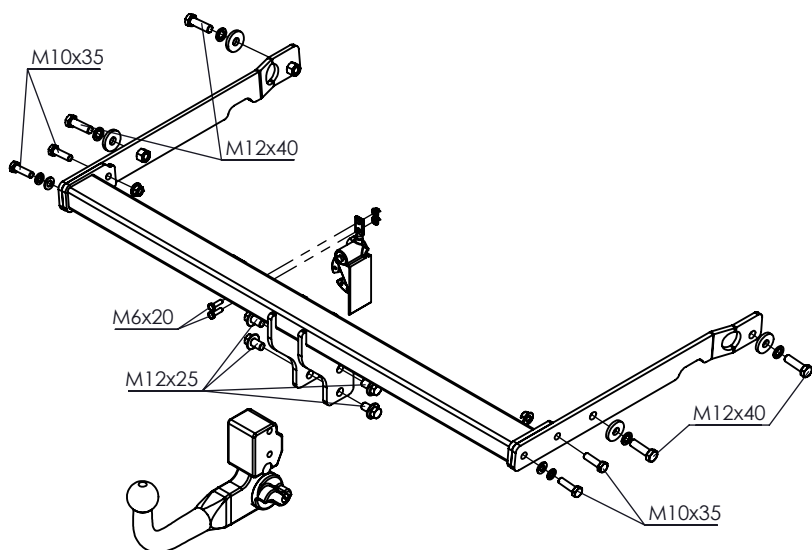

Spiske vijačnega materiala

Količina	Naziv
1	ACS 6017
2	A10 DIN 125
4	A12 DIN 128
2	A10 DIN 128
4	M10x35 DIN 933
4	M12x40 DIN 933
2	M6x20 DIN 933
2	M10 DIN 6923
2	M6 DIN 6923
4	M12x20 DIN 6921
1	Nosilec električne vtičnice
4	A12 DIN 6340

Fitting instructions

Remove bumper and steel buffer beam from the vehicle. Fit the side plates in the chassis. Fit the member section between the sideplates.  
Fit the ball casing including the foldaway socket plate and strip. Tighten all nuts and bolts to torque indicated in the table.  
Affix the antenna, if present, to the cross member with tie-wraps. Fit the bumper.



8.8	
M6-10 (Nm)	M12-85 (Nm)
M8-25 (Nm)	M14-135 (Nm)
M10-50 (Nm)	M16-200 (Nm)

Towbar data

H. nm.: E26 55 R 01 1255\*00  
Type: HA20-FF 03  
Code: 209.063

**D**  
6,64 kN

Safety instruction and

1. After driving 1000 km all bolts need to be checked and tightened. At least twice per year towbar needs to be checked.
2. When mounting and dismantling towball all instructions from producer need to be followed.
3. There mustn't be any clearance between towball and housing
4. Never go beyond allowed towing weight and vertical load.
5. Always plug in into electric socket
6. Always use plastic cover for housing

Her nec d.o.o.  
Towbar manufacturer  
Spodnje Pirniče 53c  
1211 Ljubljana Šmartno

[www.hernec.si](http://www.hernec.si) / [info@hernec.si](mailto:info@hernec.si)